

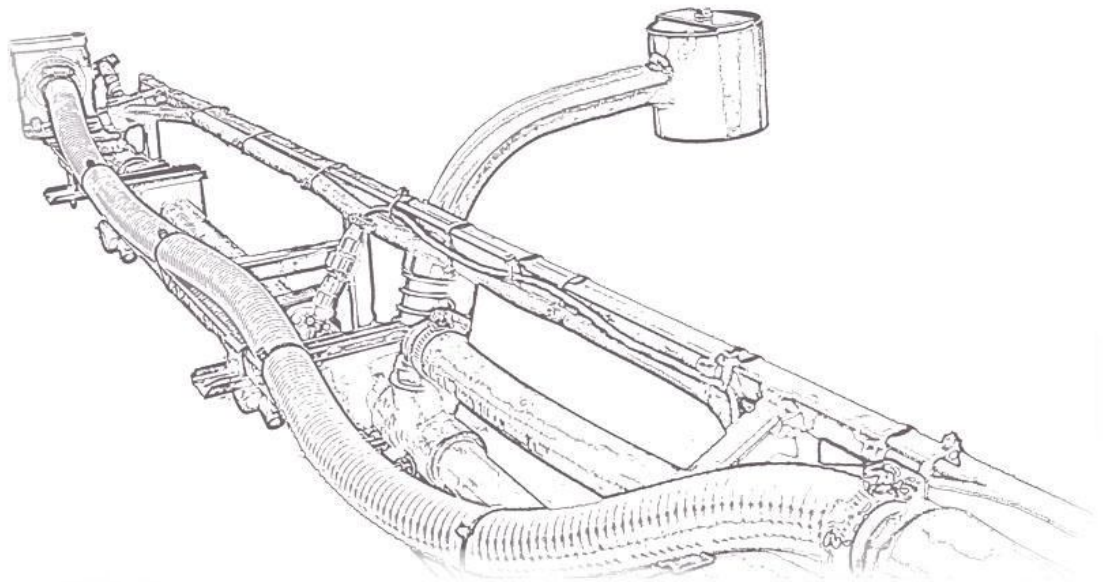

UC5TM CAN BUS Spray Height Controller



John Deere GS2 2600 and 1800
JD 4630 Display Kit
Installation Manual

Printed in Canada

Copyright © 2010 by NORAC Systems International Inc.

Reorder P/N: 54VT-GS2-SP02-INST Rev A (John Deere GS2 2600 & 1800 JD 4630 Display Kit)

NOTICE: NORAC Systems International Inc. reserves the right to improve products and their specifications without notice and without the requirement to update products sold previously. Every effort has been made to ensure the accuracy of the information contained in this manual. The technical information in this manual was reviewed at the time of approval for publication.

Contents

1 INTRODUCTION	2
1.1 List of Parts	2
2 INSTALLATION	3
2.1 John Deere 4630	3
2.2 Switch Box Installation	4
3 CABLE DRAWINGS	5
3.1 ITEM C25: 44602-01 – SWITCH REMOTE HAND CONTROL	5
3.2 ITEM C26: 43240-26 – CABLE UC5 SWITCH BOX	6
3.3 ITEM C41: 43220-03 - CABLE UC5 NETWORK 14 AWG - 3M.....	7
3.4 ITEM C40: 43260-08 – CABLE UC5 CAN BUS 4 PIN DT	8

1 Introduction

The John Deere GS2 2600 and 1800 Display Kit Manual is intended to be used in conjunction with the UC5 Spray Height Control Installation Manual. This manual provides instructions to interface the UC5 Control Module to the John Deere GS2 2600 and 1800 Display. For installation of the rest of the UC5 Spray Height Control System please refer to the sprayer specific manual provided with the kit.

1.1 List of Parts

Item	Part Number	Name	Quantity
C25	44602-01	BOX SWITCH UC4 REMOTE HAND CONTROL VER.1 RMR	1
C26	43240-26	CABLE UC5 SWITCH BOX	1
C40	43260-08	CABLE UC5 INTERFACE CAN BUS 4 PIN DT	1
C41	43220-03	CABLE UC5 NETWORK 14 AWG 3M	1
M01	UC5-BC-MANUAL-NS	MANUAL UC5 OPERATORS - NORAC	1
M04	54VT-GS2-SP02-INST	MANUAL UC5 DISPLAY KIT JOHN DEERE GS2 2600 & 1800 (JD 4630)	1

2 Installation

The following instructions are for installation on a John Deere 4630 sprayer.

2.1 John Deere 4630

1. Securely mount the control module (E01) inside the sprayer cab.
2. Tee the CAN-bus interface cable (C40) in to the John Deere CAN-bus. The John Deere CAN-bus connection can be found in the right hand armrest. The connector is a 4 pin Deutsch plug labeled “CAN 2”.
3. Connect the 6 pin Deutsch plug on cable C40 to the end of the control module with only one Deutsch connector.

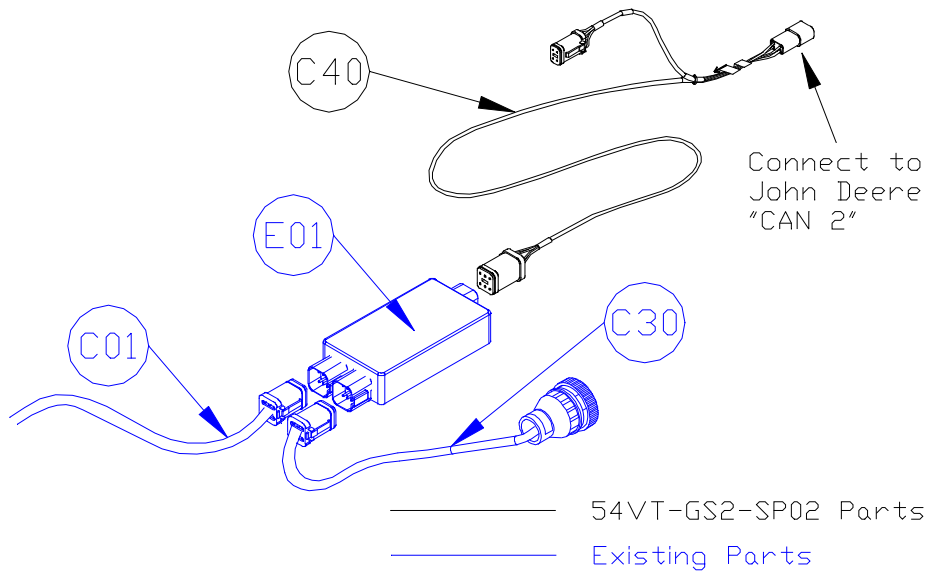

Figure 1: GS2 2600 Display Kit – 4630 Sprayer

2.2 Switch Box Installation

1. This step of the installation assumes that the input module and all required cables are installed.
 2. Disconnect cable C20 (*Thru 2* connector) from the Input Module (E03). Remove the wedge from the face of the 12 pin Deutsch plug. The wedge is removed by inserting a small flat implement underneath the wedge and lifting it up.
 3. Insert the Roll CW pin from C26 into position 3 of the 12 pin plug on C20. Insert the Roll CCW pin from C26 into position 4 of the 12 pin plug on C20. Insert the wedge back into the plug. Connect C20 to the *Thru 2* connector on the Input Module.
 4. Connect the 12 pin Deutsch plug on C26 to the *OEM 3* connector on the input module. Route the other end of the cable to the hitch of the sprayer (pull type) or to the cab (self propelled).
 5. Attach the switch box (C25) inside the cab and connect it to cable C26. An extra label is provided with the switch box if you prefer to remove the switches from the housing and mount them in the existing sprayer switch panel.
- * *Some sprayer types may not use all the switch functions.*

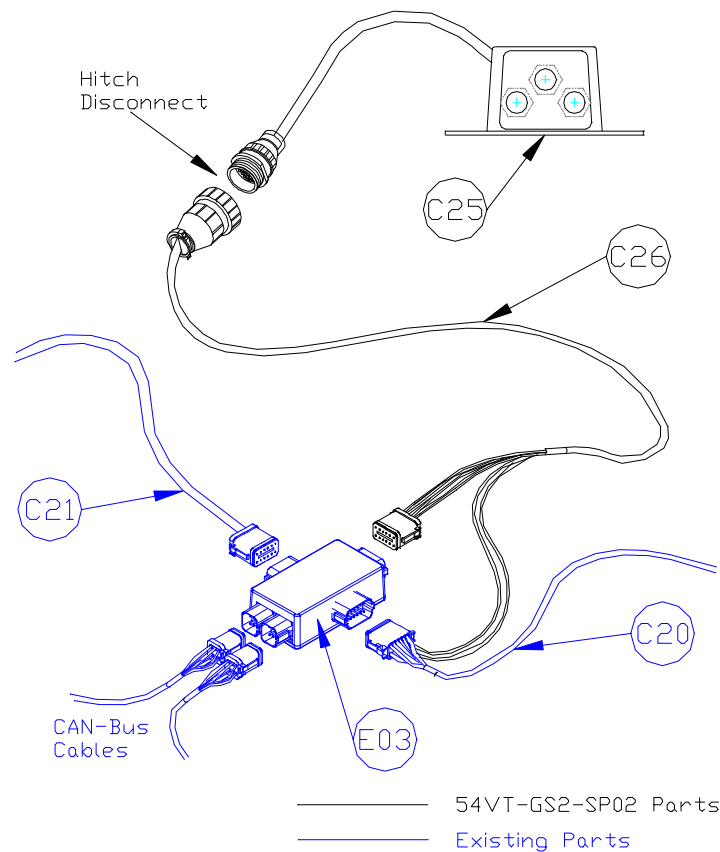
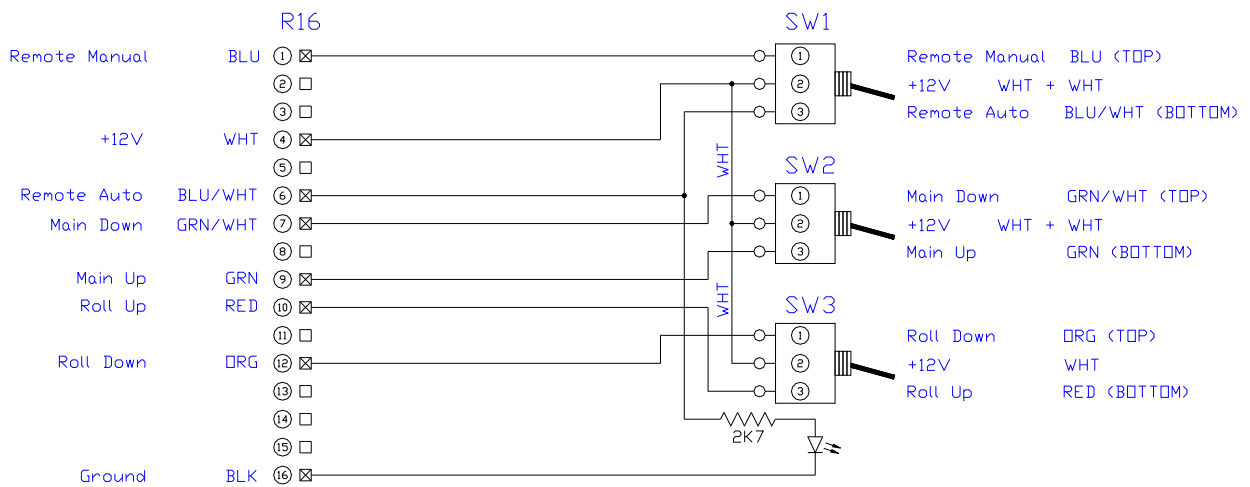
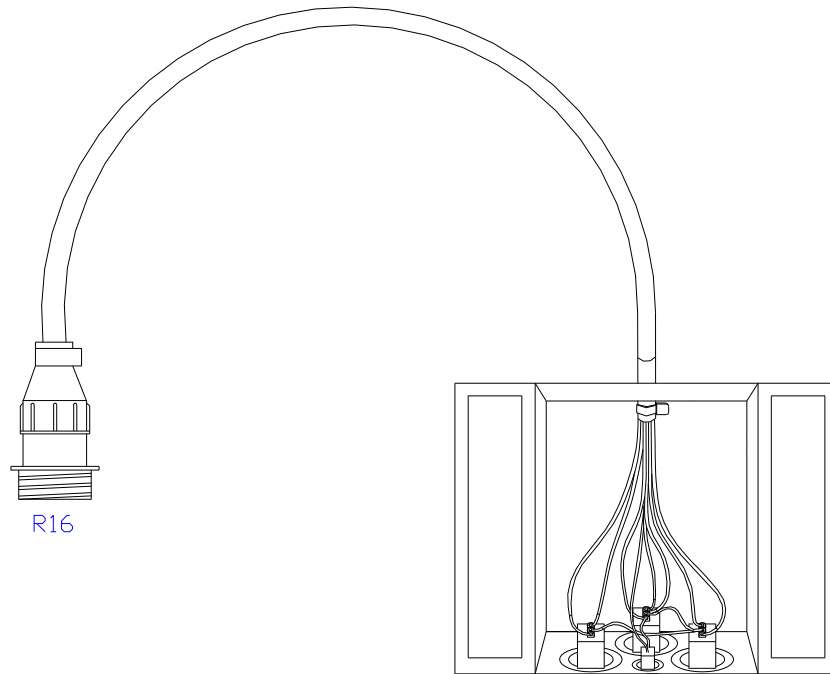

Figure 2: Switch Box Installation

3 Cable Drawings

3.1 ITEM C25: 44602-01 – SWITCH REMOTE HAND CONTROL



3.2 ITEM C26: 43240-26 – CABLE UC5 SWITCH BOX

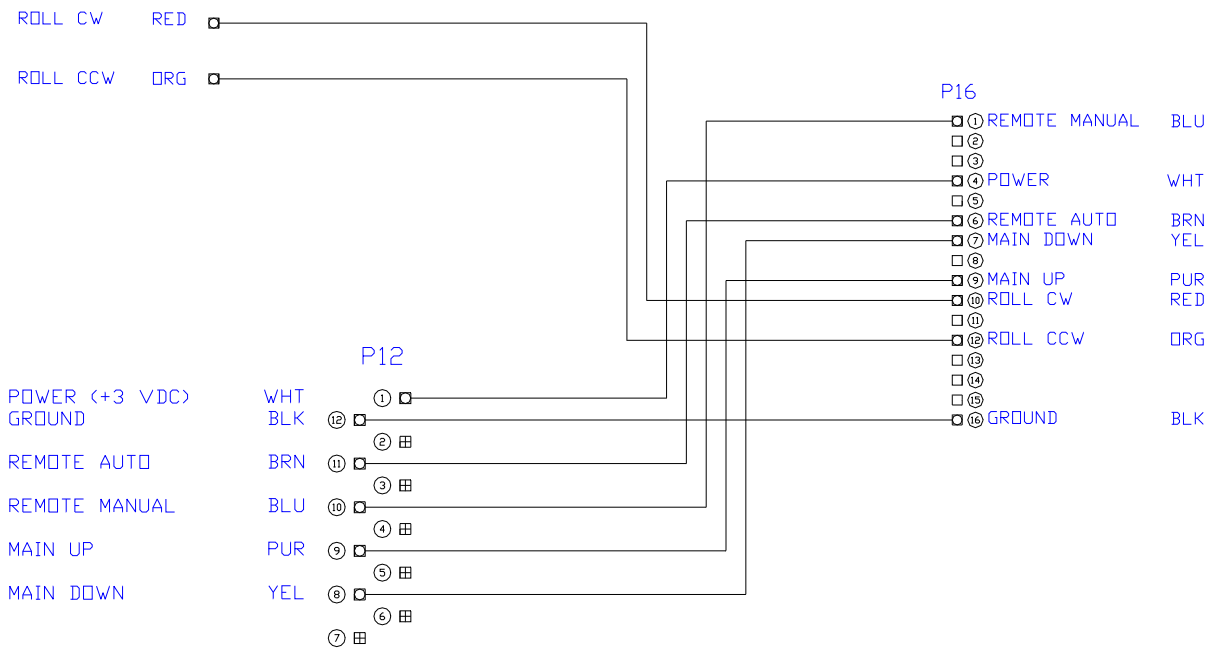
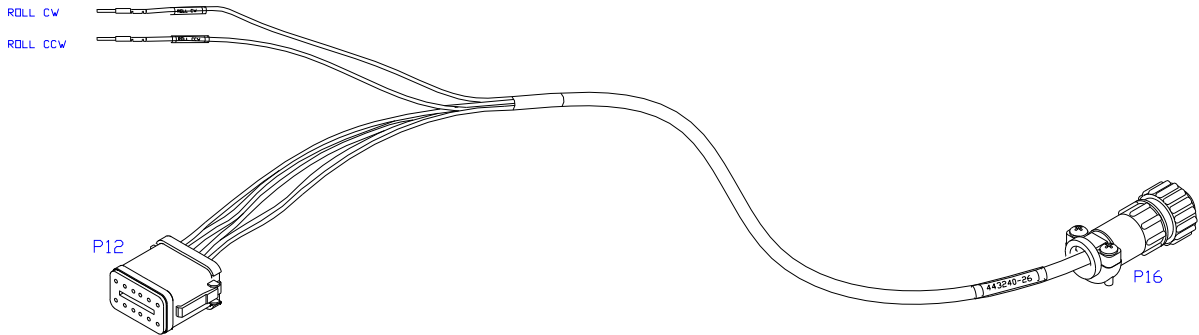

3.3 ITEM C41: 43220-03 - CABLE UC5 NETWORK 14 AWG - 3M

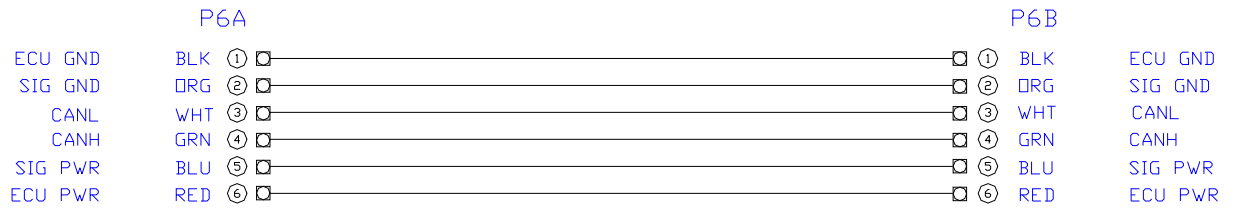
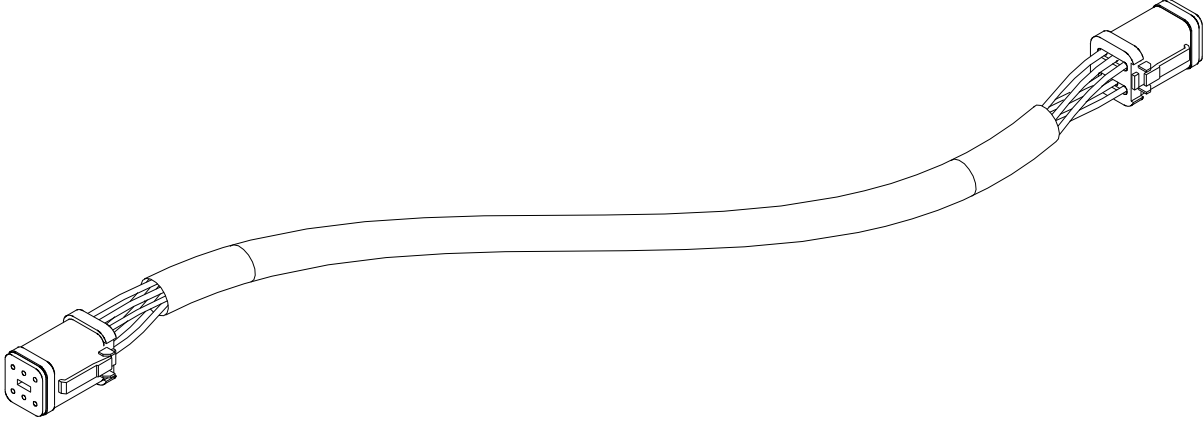

3.4 ITEM C40: 43260-08 – CABLE UC5 CAN BUS 4 PIN DT

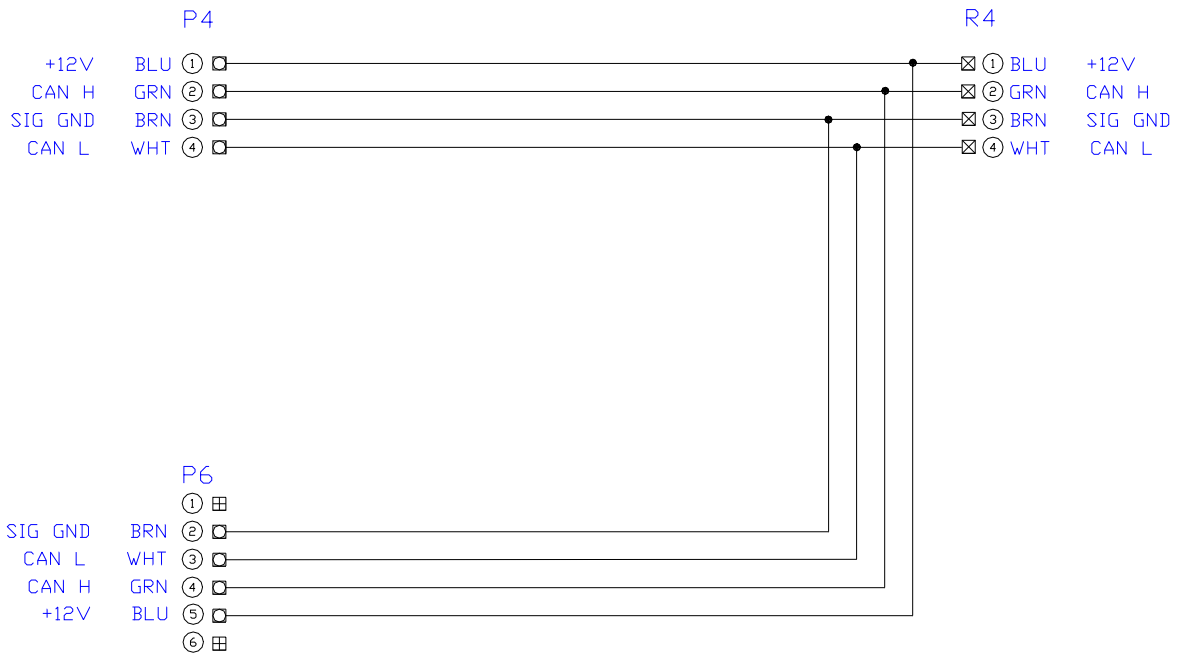
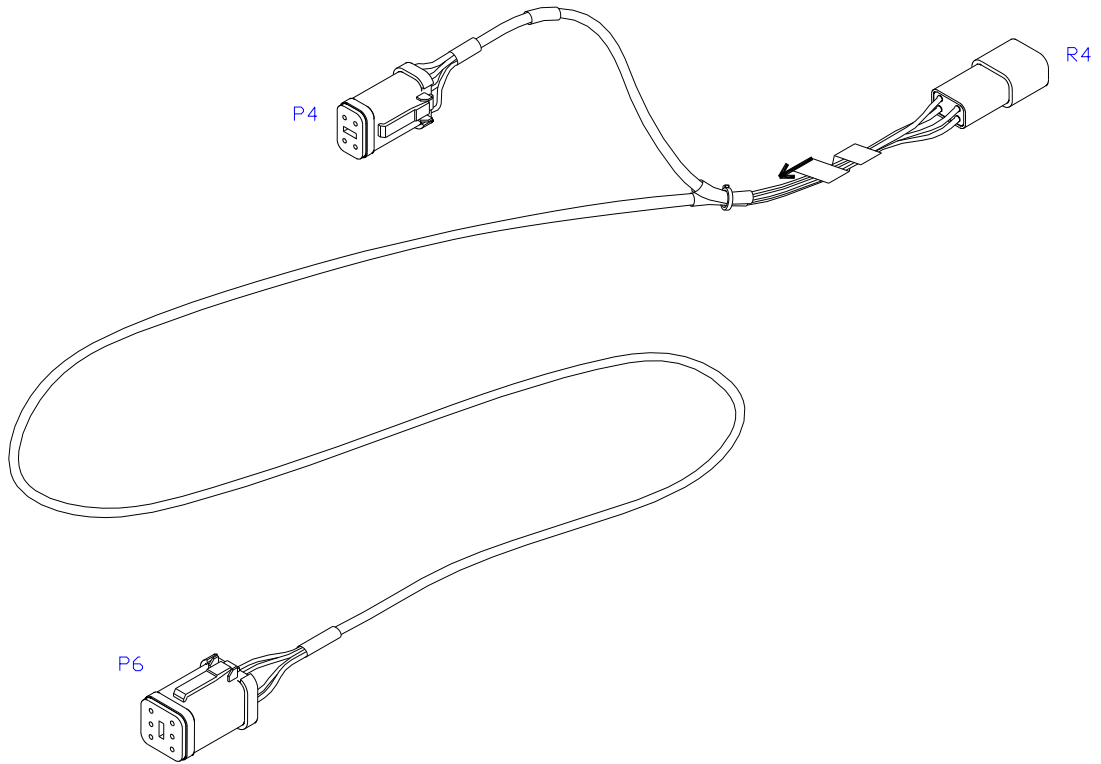

Canada
NORAC Systems International Inc.

Phone: (+1) 306 664 6711

Toll Free: 1 800 667 3921

Shipping Address:

3702 Kinnear Place

Saskatoon, SK

S7P 0A6

United States

NORAC, Inc.

Phone: (+1) 763 786 3080

Toll Free: 1 866 306 6722

Shipping Address:

1290 Osborne Rd NE, Suite F

Fridley, MN

55432-2892

Europe

NORAC Europe

Phone: (+33) 06 03 87 80 78

Shipping Address:

Rue de l'hermitage

01090 GUEREINS

France

www.norac.ca

NORAC 